

DAFNESTONE

Articolo: DAFNESTONE
Materiale: Marmo come da nostro campionario.
Troppopieno: NO
Peso lordo: kg 550 ca.
Peso netto: kg 450 ca.
Dimensione imballo: cm 220 x 115 x 80
Capacità: l 265 ca.

Descrizione: Vasca da bagno ovale in pietra, completa di piletta con sistema di scarico a pressione klik-clak.
N.B: Si consiglia di effettuare un pozzetto ispezionabile esterno al perimetro della vasca, il più vicino possibile al sistema di scarico.

* La dimensione è in base al tipo di tubo di scarico utilizzato.

Article: DAFNESTONE
Material: Marble as per our samples.
Overflow: NO
Gross weight: kg 550 ca.
Net weight: kg 450 ca.
Packing dimensions: cm 220 x 115 x 80
Capacity: l 265 ca.

Description: Oval stone bathtub complete with drain pipe fitting and pressure plug.
P.S: We advise an exterior inspection window close to the border of the tub and near the drain pipe.

*The dimension depends on the type of drainpipe used.

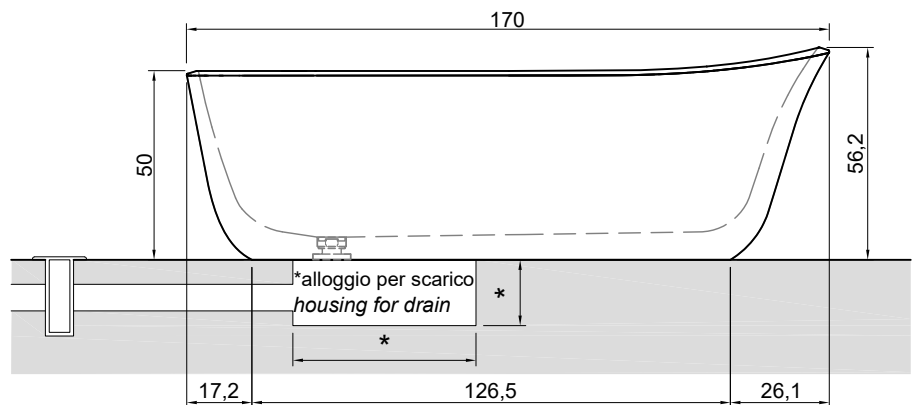
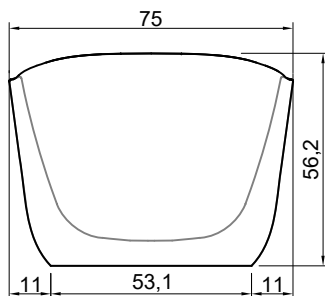
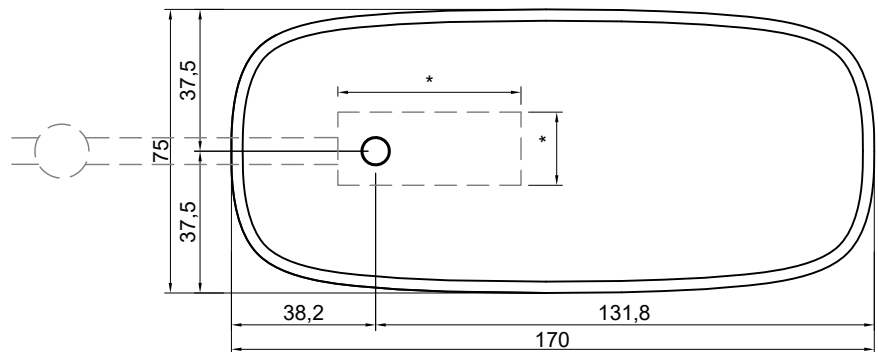
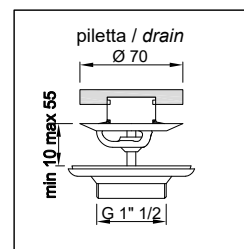

DAFNE



Articolo: DAFNE
Materiale: CRISTALPLANT® biobased
Troppopieno: SI
Portata: l/s 0,63
Peso lordo: kg 116 ca.
Peso netto: kg 80 ca.
Dimensione imballo: cm 180 x 90 x 81
Capacità*: l 275 ca.
 *Considerando il limite di capienza al troppopieno

Descrizione: Vasca da bagno ovale in Cristalplant, completa di piletta con sistema di scarico a pressione klik-clak, sifone e tubo flessibile.

Article: DAFNE
Material: CRISTALPLANT® biobased
Overflow: YES
Flow rate: l/s 0,63
Gross weight: kg 116 ca.
Net weight: kg 80 ca.
Packing dimensions: cm 180 x 90 x 81
Capacity*: l 275 ca.
 *Considering the capacity of water to the overflow

Description: Oval Cristalplant bathtub complete with drain pipe fitting and pressure plug, siphon and flexible hose.

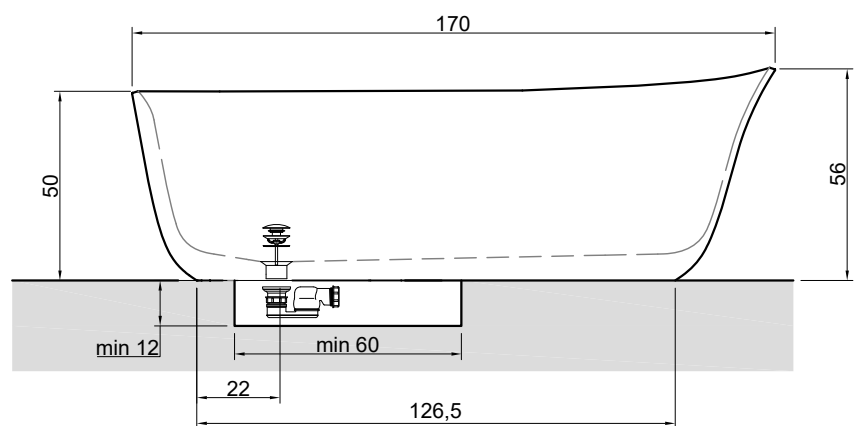
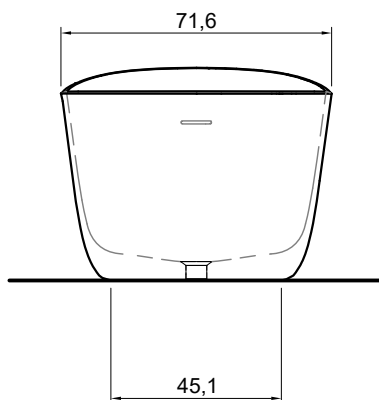
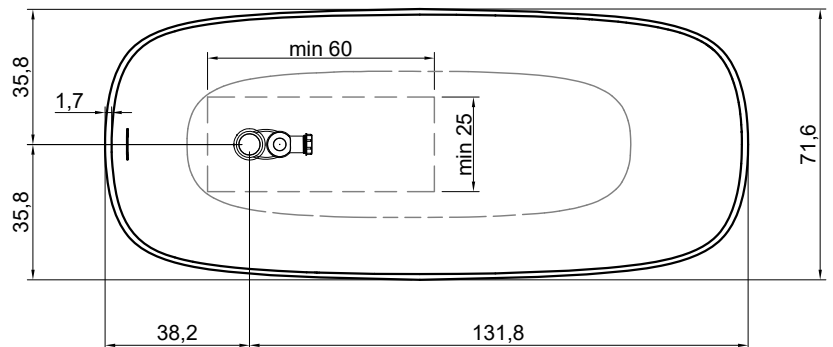
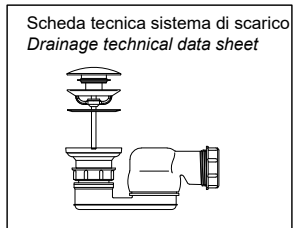

ATTENZIONE

Si declina ogni responsabilità relativa ad eventuali inesattezze contenute in queste istruzioni dovute ad errori di trascrizione.

WARNING

We decline all responsibility and eventual inaccuracy contained in the instructions due to transcript errors.

ATTENTION

Nous ne nous retenons pas responsable des erreurs éventuelles contenu dans ces instructions dues à une mauvaise transcription.

ACHTUNG

Für eventuelle Fehler bei der Übersetzung der technischen Liste weißt Antonio Lupi Design S.p.A jegliche Verantwortung von sich.

ATENCIÓN

Declinamos cualquier responsabilidad por eventuales inexactitudes contenidas en estas instrucciones debidas a errores de transcripción.

ВНИМАНИЕ

Компания снимает с себя любую ответственность за возможные неточности, содержащиеся в данных инструкциях и возникшие при перепечатке материалов.

antoniolupi

73

VIA MAZZINI

75

Antonio Lupi Design S.p.A.
via Mazzini 73/75 - 50050 Stabbia
Cerreto Guidi (Firenze) - Italy
T +39 0571 586881_95651
F +39 0571 586885
www.antoniolupi.it
lupi@antoniolupi.it